

Solar Power Station Wiring Diagram

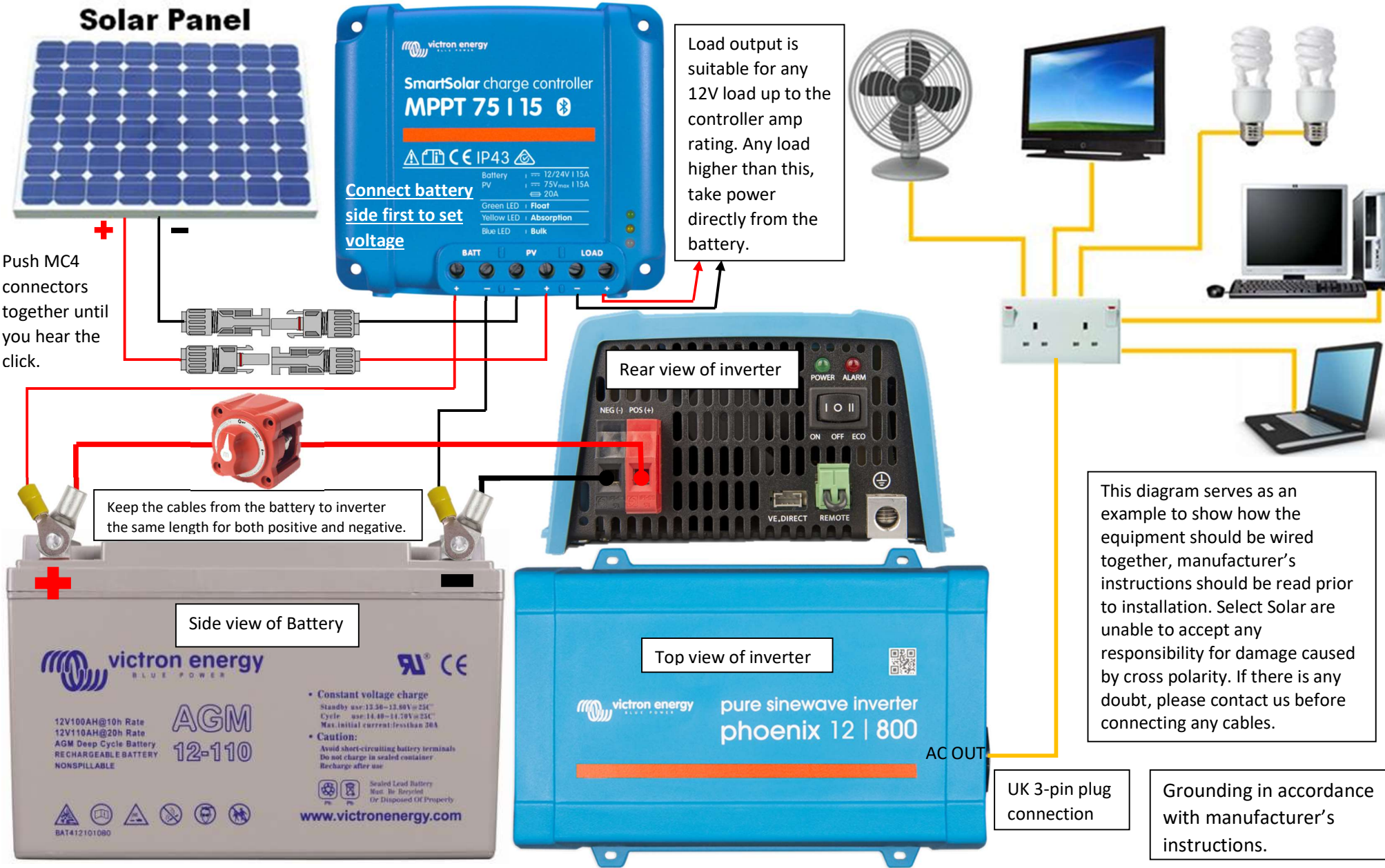

Push MC4 connectors together until you hear the click.

Load output is suitable for any 12V load up to the controller amp rating. Any load higher than this, take power directly from the battery.

This diagram serves as an example to show how the equipment should be wired together, manufacturer's instructions should be read prior to installation. Select Solar are unable to accept any responsibility for damage caused by cross polarity. If there is any doubt, please contact us before connecting any cables.

UK 3-pin plug connection

Grounding in accordance with manufacturer's instructions.