

Solara M Series 12Wp Semi-Flexible Panel Marine Kit

Wiring Diagram

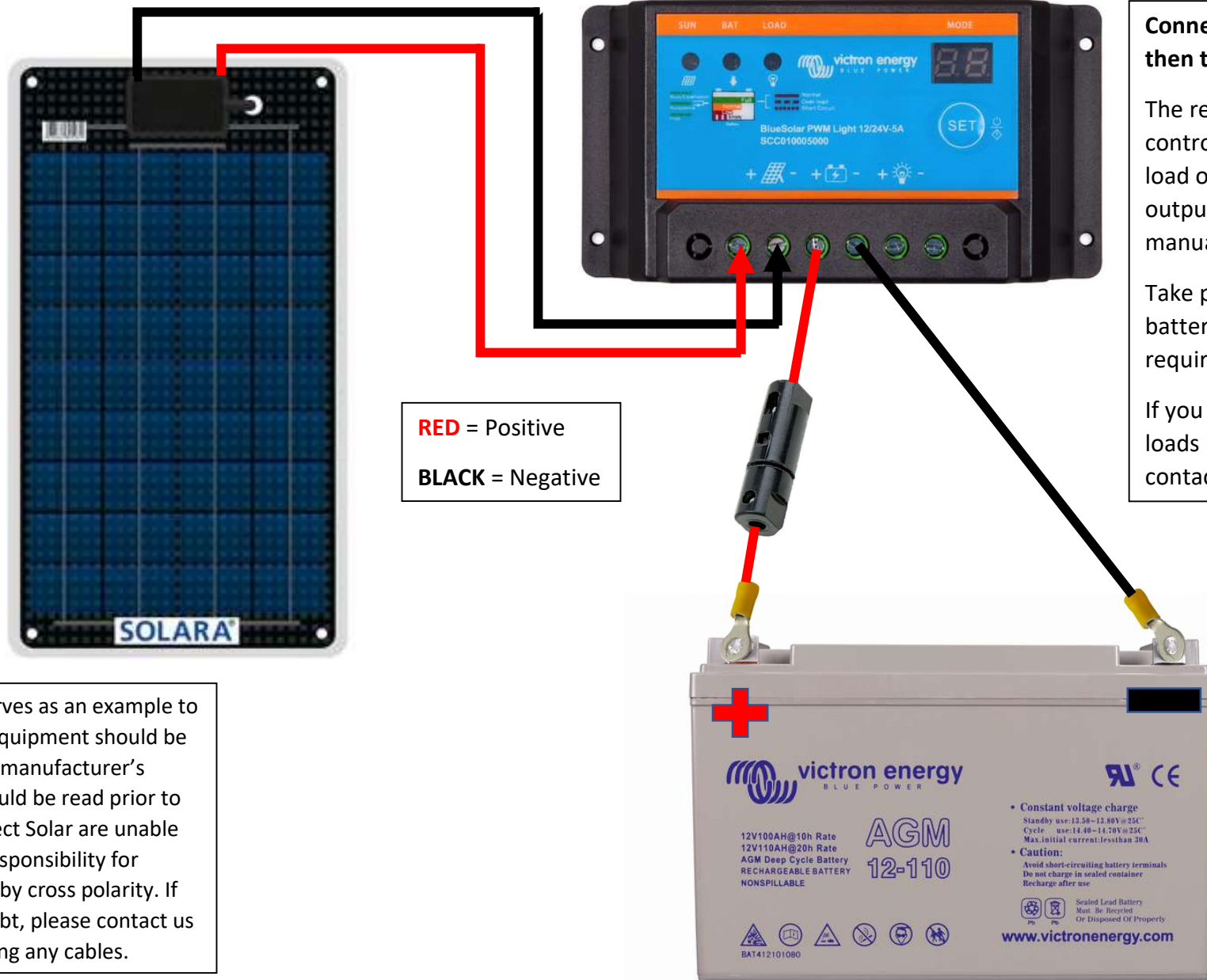

Connect the battery cables first, then the solar.

The remaining terminals on the controller are for a programmable load output. This has a maximum output of 5 amps, follow the manual for the different pre-sets.

Take power directly from the battery if more than 5 amps is required.

If you require battery protection of loads larger than 5 amps, then contact us about this.

This diagram serves as an example to show how the equipment should be wired together; manufacturer's instructions should be read prior to installation. Select Solar are unable to accept any responsibility for damage caused by cross polarity. If there is any doubt, please contact us before connecting any cables.